

Operator Instruction Supplement

Mercedes-Benz Sprinter Luton Van

March 2019 on





The illustrations, technical information, data and descriptions contained in this publication, were correct at the time of going to print. VFS (Southampton) Ltd reserve the right to make any changes necessary in line with continuous development and improvement.

No liability can be accepted for any inaccuracies or omissions in this publication, although due care has been taken to make it as complete and accurate as possible. This publication includes aftermarket options that are available for Luton Van, therefore, some of the items covered in this supplement may not be supplied with your vehicle.

This publication may not be duplicated, reprinted, stored in a data processing system or transmitted by electronic, mechanical, photographic or other means, or recorded, translated, edited, abridged or expanded without the prior written consent of VFS (Southampton) Ltd.

The same also applies for parts of this manual and there use in other publications.

© Copyright 2019. Issued by VFS (Southampton) Ltd. Part No: VFS08-82-016 issue 2.

Table of Contents

Introduction 3

Symbols and Glossary 4

Parts and Accessories 5

Safety First 6

Warranty 7

Loading 8

Load Securing Methods 9

Shutter Door Handle and Lock 11

Emergency Door Release 12

Optional Tail-lift 13

Rear Steps and Grab Handles. 15

Side and Rear End Outline Marker Lamps. 16

Interior Lamp 17

Luton Head 17

Aftersales 18

Index 19

Notes. 20

Introduction

This Operator Instruction Supplement must be referred to in addition to the standard Mercedes-Benz Sprinter owner's handbook. Read and understand both manuals and familiarise yourself with the vehicle before operating the vehicle on the road.

Note: This handbook only details the features on the Luton Van Body that are not covered in the standard vehicle owner's handbook, therefore it is imperative that this supplement is kept with the standard vehicle owner's handbook.

Note: Always use and operate your vehicle in line with all applicable laws and regulations.

Note: Pass on this supplement when selling your vehicle; it is an integral part of the vehicle.

Symbols and Glossary

Symbols in this handbook

WARNING



You risk death or serious injury to yourself and others if you do not follow the instructions highlighted by the warning symbol.



When you see this symbol, read and follow the relevant instructions in this handbook.

CAUTION



You risk damaging your vehicle if you do not follow the instructions highlighted by the caution symbol.

Safety First

WARNING



Transporting goods is a potentially hazardous operation. It is essential that all operators fully understand the procedures detailed in this handbook and are aware of the features and controls. Health and Safety legislation must be strictly applied. UK Construction & Use Regulations must be observed when operating the vehicle on the public highway.

It is the responsibility of the Driver, Owner and/or Operator to establish what Health and Safety legislation applies when using this vehicle and that only persons trained and qualified in line with that legislation be allowed to use this equipment.

Depending on the circumstances and the territory that the vehicle is being used, other legislation may apply. Always check that existing legislation has not been updated or superseded, and whether new legislation has been introduced.

Parts and Accessories

Spare parts and Accessories are available from: VFS (Southampton) Ltd, Unit 8, Barton Park Industrial Estate, Chickenhall Lane, Eastleigh SO50 6RR

Tel: 023 8065 1704 Fax: 023 8062 0999 Email: parts@vfs.co.uk

Detailed information can be found in the Spare Parts and Accessories section of VFS's website. www.vfs-parts.co.uk.

Warranty

Full warranty exists on all parts and workmanship associated with the Luton Van conversion for 3-year/unlimited miles. Warranty is only valid if the Luton Van is operated in accordance with the Supplementary Owners Handbook and current Road Traffic Act legislation.

Warranty claims for parts associated with the Luton Van conversion should be made direct to VFS Ltd.

Contact details:-

VFS (Southampton) Ltd.,
Unit 8
Barton Park Industrial Estate,
Chickenhall Lane
Eastleigh
Hants
SO50 6RR

Tel: 023 8065 1704

Fax: 023 8062 0999

E-mail: parts@vfs.co.uk

Web address: www.vfs.co.uk

Loading



- Risk assessment and a loading plan prepared by someone competent to do so is the key to good load security. This doesn't have to be a difficult process but 'thinking through' the operation in advance may identify potential issues before they become a problem.
- Prior to loading, ensure that the Shutter door is fully open.
- Avoid dropping loads on to the floor board.
- Loads should be placed against the Box Body front panel if possible. If this is not possible for reasons of weight distribution, the gap to the front panel should be filled with suitable material, or Shoring poles should be used.
- Always secure any loads with industry approved straps using the load lash rails provided on the body sides.
- Loads should be secured so that they do not move relative to the Box Body during transport.
- Friction alone should not be relied on as a method of load securing.
- Do not use the grab handle to lash loads.

Load Securing Methods



- Webbing straps secured to side rails to prevent loads sliding longitudinally along the Box Body bed.
- Restraint bars/Shoring poles that lock into side rails to partition the load along the length of the Box Body.
- Positive locking loading so that the load is tightly packed to the headboard and side walls.
- Do not secure loads to Grab Handle.

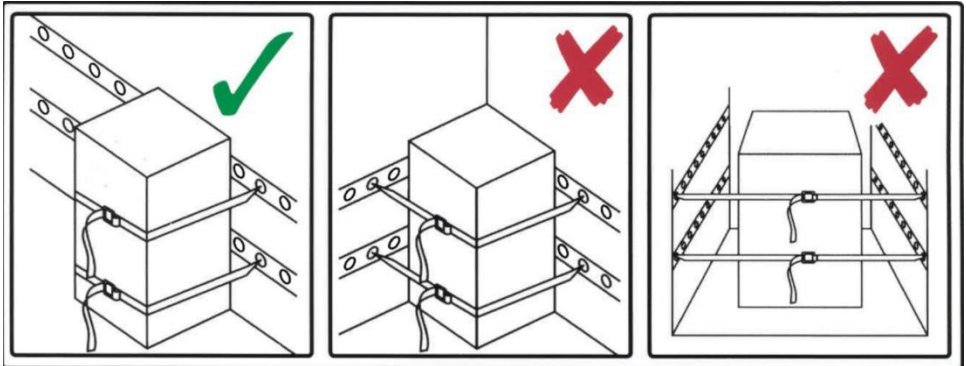

Load Securing Methods

Load Lashing Rails:

Luton Van bodies are fitted with three levels of lashing rails as standard. The rails are situated along both body sides and across the forward bulkhead.

The rails should be used in combination with suitable webbing straps or Shoring poles to secure loads.



Load Lashing Rails in Box Van

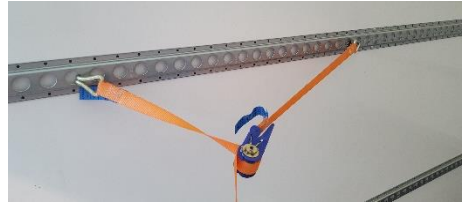

Example of Webbing Usage

Webbing Straps:

Suitable strength webbing straps should have hook features that will fit into holes within lashing rails.



Webbing Hook in Fully Engaged Position

Shoring Poles:

Shoring poles can be used across the vehicle by fitting each end into corresponding rail holes either side of the box. Poles are sprung loaded and are fitted by inserting one end of the pole on one side then compressing the opposite end thus making it short enough to fit within the rails, releasing pressure gently, whilst guiding it into the opposite rail hole.



Shoring Poles

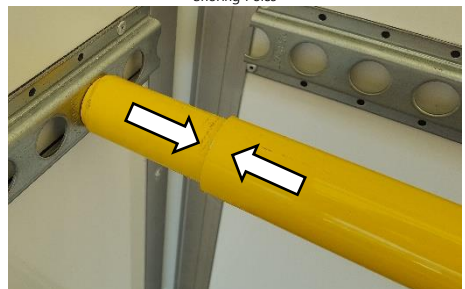

Shutter Door Handle and Lock



Always be mindful that unsecured loads could have moved during transport and could be pressing on shutter door.

Shutter Door:

All Luton Vans are fitted with a lockable shutter door. To unlock the shutter door, insert key and rotate clockwise 360°.

To open the shutter door pull the bar handle towards you, unhook it from the side catches and slide shutter upwards. Continuous upward pressure is required to raise the door to the height required.



Door Lock

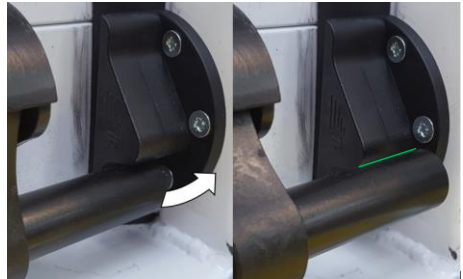

Pull Bar Release Mechanism



Opening the Door



Ensure that the Roller Shutter door is closed and Tail-lift is fully raised and stowed before driving the vehicle.

Shutter Door Handle and Lock

To close the door, pull down on the elasticated pull strap until the yellow angle feature can be reached, then push fully down on angle feature to allow pull bar handle to engage with side catches. Ensure pull handle bar is securely wrapped beneath retaining catches before locking door.



Elastic Pull Strap for Shutter Door

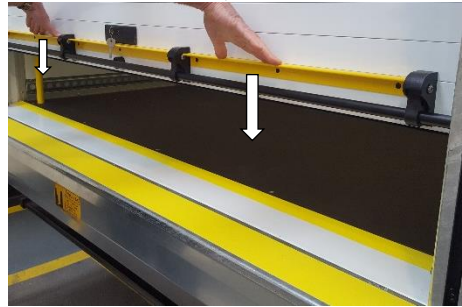

Closing the Door



Caution – Do not use opening bar for closing shutter door as hands could be trapped. Use angle feature provided.

Emergency Door Release:

To escape from the vehicle in the event that the door has been closed inadvertently, push the release button and raise the door using handles.

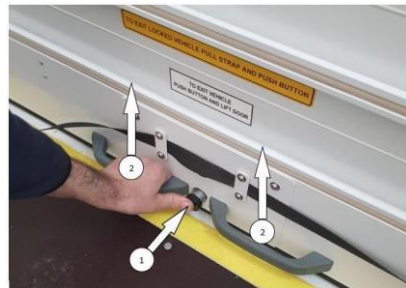

Internal Door Emergency Release

To escape from the vehicle in the event that the door has been closed and locked from the outside, pull on the release strap and push the release button simultaneously and raise the door using handles.

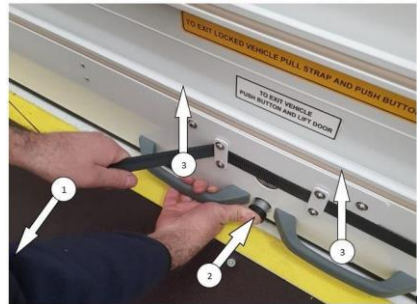

Internal Door Emergency Release Strap

Tail-lift

Tail-lift operation:

Power to the Tail-lift is provided by the in-cab Tail-lift Isolation Switch located between the driver and passenger seats. A warning sounder will operate whilst the switch is in the on position.

Turn the switch clockwise to activate the tail-lift, and anti-clockwise to disable the tail-lift.

The external controller is located on the rear left corner of the vehicle behind the left-hand taillight.

Press the raise button to lift the platform out of the locking feature. Raise the catch by hand and open platform.

Lower platform to the ground using external controller.



Ensure feet are clear of platform when lowering.



Tail-lift Isolation Switch Location



Tail-lift Isolation Switch 'ON' / 'OFF' Positions



External Controller Location

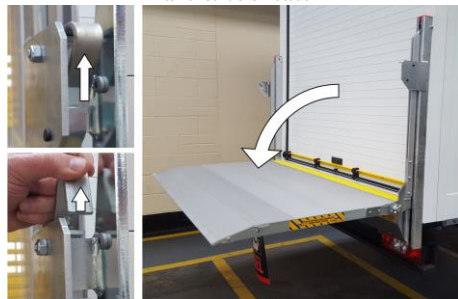

Tail-lift Deployment

Tail-lift

To switch between the external and internal controller, use the selector switch on the internal controller.

To close the platform, ensure the external controller is activated before closing the roller shutter door.

Then using the external controller raise the Tail-lift to its maximum position. Lift the platform until it is secured by the safety catch. Lower the platform into the locking feature.

When the Tail-lift is stowed, turn the Tail-lift isolation switch to the "OFF" position.



Internal Controller with Internal/External Switch



Tail-lift Stowing



Tail-lift Isolation Switch 'ON' / 'OFF' Positions



- Ensure the isolation switch is in the "OFF" position before driving the vehicle.



- When opening Tail-lift take special care and check for pedestrians, cyclists and passing traffic.



- Never leave the Tail-lift at load floor level if leaving the vehicle, either fully lower or raise and stow against rear of vehicle.



- Do not drive with Tail-lift open or unsecured.

Interior Lamp

Luton Van bodies are fitted with an interior work lamp to illuminate the load space in poor light conditions.

The work lamp is situated at the top of the full height grab handle and can be swivelled to illuminate the required load area.

Power is provided when the in-cab Tail-lift Isolation Switch is turned on. A warning sounder will operate whilst the switch is in the on position.

The lamp is automatically operated by a motion (PIR) sensor on the grab handle support bracket. The operation is set to turn off after 5 minutes unless it senses movement within the box, or around the rear of the vehicle within the PIR range.



Interior Worklamp, Motion (PIR) Sensor, and Internal Controller



Interior Worklamp Movement



Side Marker Lamps

Obligatory Side Marker Lamps are fitted to all Luton Vans.

These are designed to function when the vehicles sidelights are switched on.

Lamps are non-serviceable parts. Replacements can be through the Mercedes dealer network.

Luton Head

The Luton head is capable of carrying a maximum load of 50kg.



The load should be evenly distributed.



The Luton Head is designed to carry low weight/high volume loads up to 50kg. e.g. Blankets, Spare load retaining straps, Packaging, etc.



Avoid throwing/loading sharp objects which may damage outer skin of GRP Luton Head.

Maintenance

Driver Checks and Maintenance Items:

CAUTION



It is imperative that the recommended Driver Checks and Maintenance be carried out to ensure the safe and efficient operation of the Luton Van.

The driver, regardless of ownership of the vehicle must perform the following checks and vehicle maintenance. If the driver does not own the vehicle, the owner of the vehicle must satisfy himself or herself that the driver to whom the vehicle has been allocated will carry out these essential checks. The driver must be made aware of their responsibilities to read and understand the Operator Instruction Supplement and carry out the essential Maintenance Checks in line with the maintenance procedure in this section.

Driver Daily Checks:

- Check the Operator Instruction Supplement is complete and located in a safe position within the cab
- Check correct operation of all vehicle functions
- Check the Shutter door raises and lowers correctly
- Check shutter door lock mechanism and emergency release functions
- Check shutter door lift bBar mechanism. Ensure the lift bar pivots freely and latches correctly in the door closed position
- Check the operation of the in-cab Tailift Isolation switch and listen for the Warning Buzzer operation
- Check Tailift operation on both internal and external controller functions
- Check Tailift platform latches correctly in the stowed position catch
- Check function of load area work lamp

Weekly Driver Checks:

- General overall body inspection for damage or wear
- Inspect Emergency Door Release push button and release strap for damage or wear
- Inspect balance bar to door connecting cables for wear or damage
- Inspect the door Elasticated Pull Cord for wear or damage
- Check all Information decals for wear or damage and they are present

Aftersales

Parts and Accessories

Spare parts and Accessories are available from: VFS (Southampton) Ltd,
Unit 8, Barton Park Industrial Estate, Chickenhall Lane, Eastleigh SO50 6RR

Tel: 023 8065 1704 Fax: 023 8062 0999 Email: parts@vfs.co.uk

This Operator Instruction Supplement, Spare Parts and Accessories can be found and downloaded, in the relevant section on-line at www.vfs-parts.co.uk

European Whole Vehicle Type Approval (WVTA)

VFS installed Luton Van and Accessories i.e. Tail-lifts etc. have full EC WVTA approval.

The picture illustrates the position
(Driver's Seat Pedestal) of the
"Second Stage Approval" Decal.



Warranty

Full warranty exists on all parts and workmanship associated with the Luton body conversion for 3-years/ unlimited miles.

Warranty is only valid if the Luton Van is operated in accordance with the Owner's Handbook and current Road Traffic Act Legislation.

Warranty claims for parts associated with the Luton body conversion should be made direct to VFS (Southampton) Ltd.

Index

Description	Page
D Doors – Roller Shutter	10, 11, 12, 17
E Emergency Door Release	11 , 12
G Grab Handle	8, 9, 15, 16
H Handles	8, 10, 11, 12, 15
I Interior Work Lamp	15
L Lamps	17
Loading/Load Securing Retention	8, 9, 10
Locks	11, 12, 13,14
Luton Head	16
M Maintenance	17
N Notes	20, 21
P Parts	6, 18
S Safety	6
Shutter	10, 11, 12
Side Marker Lamps	16
Symbols in this Handbook	4
T Tail-lift	13, 14
W Warranty	6, 18

